



Bhavya
Builders

www.bhavyabuilders.com

Bhavrya

VISTA

3BHK





EACH FLAT 3BHK
1330 SFT

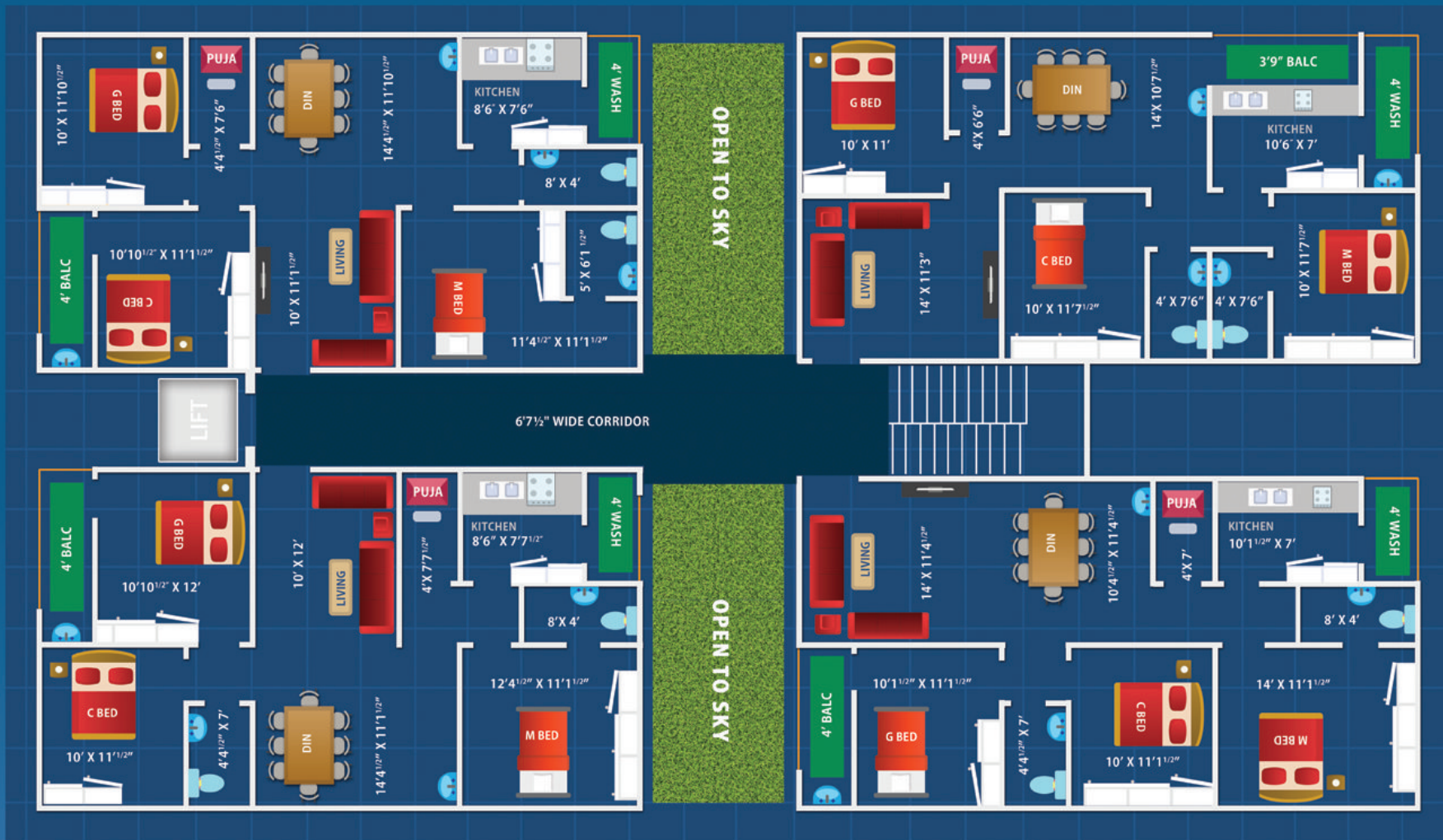

STRUCTURE:

Earthquake resistant-R.C.C Frame Structure accordance with IS code.

MAIN DOOR:

Entrance Decorative Teak Door Frame with Polish Teak Door.

FLOORING:

800mm x 800mm size vitrified tiles.

TOILETS :

Western type toilets with Glazed tiles dado up to 6' height, Flooring with anti-Skid ceramic Tiles.

EXTERNAL & INTERNAL :

Painting: Acrylic emulsion paint with Wall Putty Finish.

WATER SUPPLY :

Continuous 24hrs water Supply from Bore wells.

WALLS :

Moulded Brick with Cement mortar 6" thick exterior walls and 4" thick interior wall.

ELECTRICAL :

Concealed wiring of copper wire with necessary Points, with Modular Switches.

INTERNAL DOOR :

Granite Door Frame with Polished Flush Door.

KITCHEN :

Polished Black Granite kitchen Platform with sink, dado up to 2' height with Glazed Ceramic Tiles.

LIFT :

One Lift with ISI Standards.

GENERATOR:

Power Back Up for all common Amenities.

Bhavrya Sunrise

3BHK

EACH FLAT 3BHK
1465 SFT



EAST ROAD

ONGOING PROJECTS



BHAVYA AURORA



BHAVYA SUNRISE



BHAVYA TRINITY



BHAVYA VISTA



BHAVYA ROYAL



BHAVYA ORIENT



BHAVYA HOME



BHAVYA KRISHNA



BHAVYA ELITE



BHAVYA IDEAL



BHAVYA GRAND



BHAVYA PRIDE



BHAVYA MK SIGNATURE



BHAVYA VIVID



BHAVYA VIHAR



BHAVYA NANDAN



BHAVYA RAISE



BHAVYA DAWN



BHAVYA NIVAS

COMPLETED PROJECTS



81-01-10/7, Flat No-T2, Bhavya royal, Venkateshwara nagar,
Opp Bommuru p.s, Rajamahendravaram.

Ph: 90103 43444, 94945 21155

Website: www.bhavyabuilders.com

Email: bhavyabuilders@yahoo.com.

Site Address

Bhavya vista,
#14-6, Beside Marable Estates Road, Near morumpudi Junction,
Rajamahendravaram.

Bhavya Sunrise,
#5-702, Beside Alawal Nagar, Opp.AVA Road,
Rajamahendravaram.

+91 9948417779

Member of A.P.



Disclaimer: This brochure is only a conceptual presentation of the project and not a legal offering.
The promoters reserve the right to alter and make changes in plans, specifications, elevations and any other detail as deemed fit.